



RESIDENTIAL ESTATE AGENTS  
PROPERTY LETTING & MANAGING AGENTS  
VALUERS & PROPERTY CONSULTANTS  
CHARTERED SURVEYORS

**01722 336422**  
[www.hwwhite.co.uk](http://www.hwwhite.co.uk) WEB



**Devizes Road,**

**£1,550 PCM**

**418 Devizes Road, Salisbury, Wiltshire, SP2 9LY**



Energy Efficiency Rating		
	Current	Potential
Very energy efficient - lower running costs		
(92 plus) A		77
(81-91) B		
(69-80) C		
(55-68) D	61	
(39-54) E		
(21-38) F		
(1-20) G		
Not energy efficient - higher running costs		
England & Wales		EU Directive 2002/91/EC

An individual, extended three bedroom detached family home situated on a good sized plot with wonderful views towards Old Sarum and the surrounding countryside. The property has been greatly improved and the accommodation comprises: an entrance hall, wet room, luxury fitted kitchen with shaker style units, granite work surfaces with up stands, integrated Siemens double electric oven, microwave, electric hob, stainless steel cooker hood, built-in dishwasher, utility cupboard with plumbing for washing machine. Opening to dining/family room with lovely outlook and french doors providing access to large decking area. Full length sitting room. On the first floor are three double bedrooms, one with fitted wardrobes and a family bathroom. Outside, a tarmaced driveway leads down to a carport and wooden gates, through which is a sizeable gravelled parking/turning area and large wooden shed/workshop with power and light. Below this is a landscaped, tiered rear garden, mainly sloping lawn with greenhouse and views. The house is fully double glazed with gas fired central heating. Prospective tenants should be mindful of a busy junior school and pub within close proximity. UNFURNISHED.

A Note From the Whites Letting Team  
Thank you for considering Whites as your letting agent. As a proud member of the Royal Institution of Chartered Surveyors (RICS), we aspire to uphold its core values by providing a fair, efficient, and transparent service for all prospective tenants. Below we've outlined how we manage property enquiries and applications to help set expectations and guide you through the letting application process.

To begin the process of enquiring about one of our properties, please click the 'Request Further Details/Info' button on the property listing. This will send us your contact information, and we'll get back to you as soon as possible with a short questionnaire to complete. Once we've received your completed questionnaire, your enquiry will be registered with the relevant property.

Due to the high level of interest received and arrange view expectations, we may also

the order they are  
I. To manage

Please note that applications are considered on their merits by us, in conjunction with the property details.

carefully considered

The availability date listed

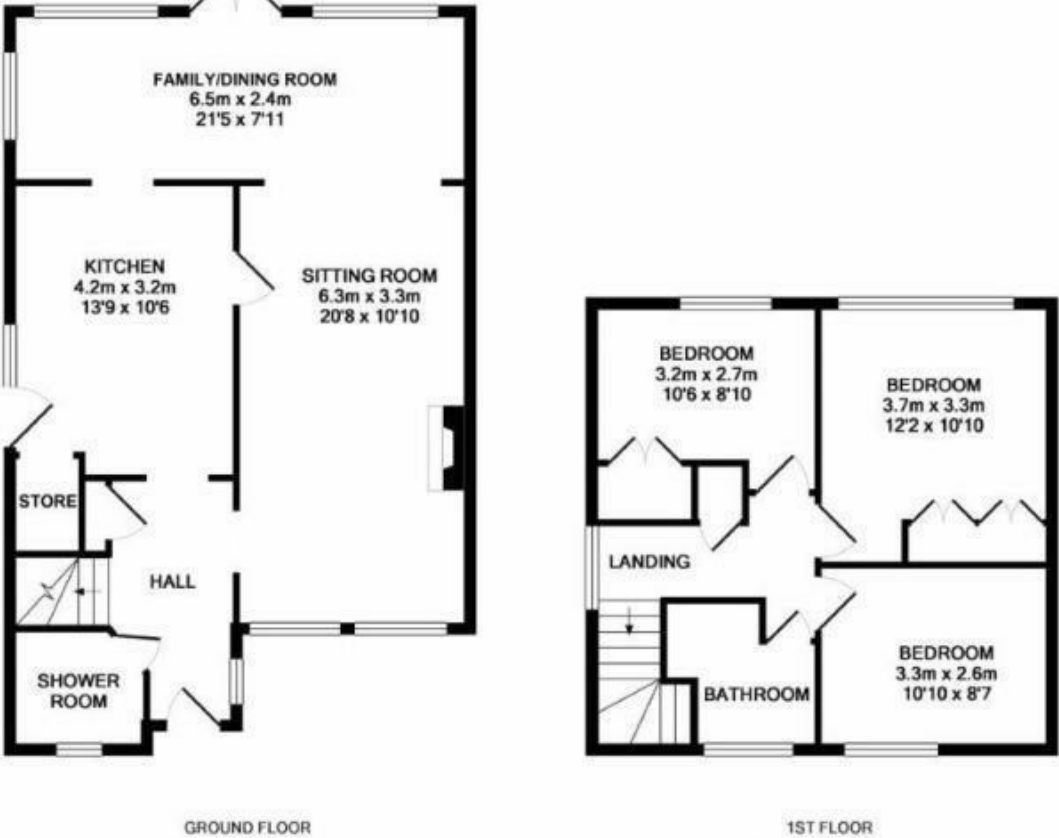

418 DEVIZES ROAD, SALISBURY

Measurements are approximate. Not to scale. Illustrative purposes only  
Made with Metropix ©2018



01722 336422

47 Castle Street, Salisbury SP1 3SP 01722 320600 FAX  
residential-sales@hwwhite.co.uk E-MAIL www.hwwhite.co.uk WEB